

This document, together with the concepts and designs presented herein, is intended only for the specific purpose and client for which it was prepared. Reuse of and improper reliance on this document without written authorization and adaptation by Kinney-Horn and Associates, Inc. shall be without liability to Kinney-Horn and Associates, Inc.

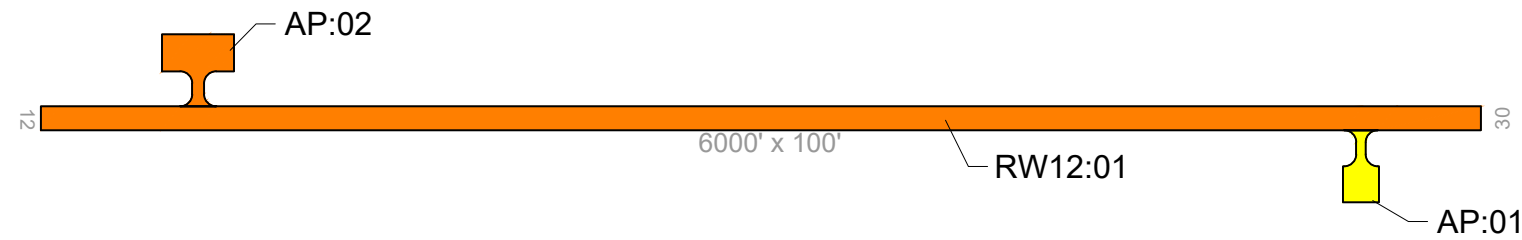

**CURRENT 2024 PAVEMENT CONDITION INDEX**

Branch ID	Section ID	Branch Name	Surface Type	Section Area (SF)	Approx. Age at Inspection	Last Major Work Date	Last Inspection Date	Pavement Condition Index	PCI Category
RW12	01	Runway 12-30	AAC	600,000	24.9	1/1/2000	10/1/2024	55	Poor
AP	01	Apron	AAC	45,000	24.9	1/1/2000	10/1/2024	56	Fair
AP	02	Apron	AAC	90,000	24.9	1/1/2000	10/1/2024	41	Poor



**LEGEND**

BRANCH IDENTIFIER  
**RW01:10**  
 SECTION IDENTIFIER  
 SECTION BOUNDARY

<span style="display:inline-block; width:15px; height:15px; background-color:darkgreen; border:1px solid black;"></span>	PCI 86-100 GOOD
<span style="display:inline-block; width:15px; height:15px; background-color:lightgreen; border:1px solid black;"></span>	PCI 71-85 SATISFACTORY
<span style="display:inline-block; width:15px; height:15px; background-color:yellow; border:1px solid black;"></span>	PCI 56-70 FAIR
<span style="display:inline-block; width:15px; height:15px; background-color:orange; border:1px solid black;"></span>	PCI 41-55 POOR
<span style="display:inline-block; width:15px; height:15px; background-color:lightpink; border:1px solid black;"></span>	PCI 26-40 VERY POOR
<span style="display:inline-block; width:15px; height:15px; background-color:darkred; border:1px solid black;"></span>	PCI 11-25 SERIOUS
<span style="display:inline-block; width:15px; height:15px; background-color:gray; border:1px solid black;"></span>	PCI 0-10 FAILED

**AIRFIELD PAVEMENT WORK HISTORY**

1. AIP-002-2005, ALL NEW CONSTRUCTION: CONSTRUCT RUNWAY 10-28 (RW10:01), TAXIWAYS (TW:01), AND APRON (AP:01).
2. AIP-005-2011, CRACK SEAL, FOG SEAL, AND REMARK ALL PAVEMENTS.
3. AIP-006-2016, CRACK SEAL, FOG SEAL, AND REMARK ALL PAVEMENTS.



This document, together with the concepts and designs presented herein, is intended only for the specific purpose and client for which it was prepared. Reuse of and improper reliance on this document without written authorization and adaptation by Kimley-Horn and Associates, Inc. shall be without liability to Kimley-Horn and Associates, Inc.

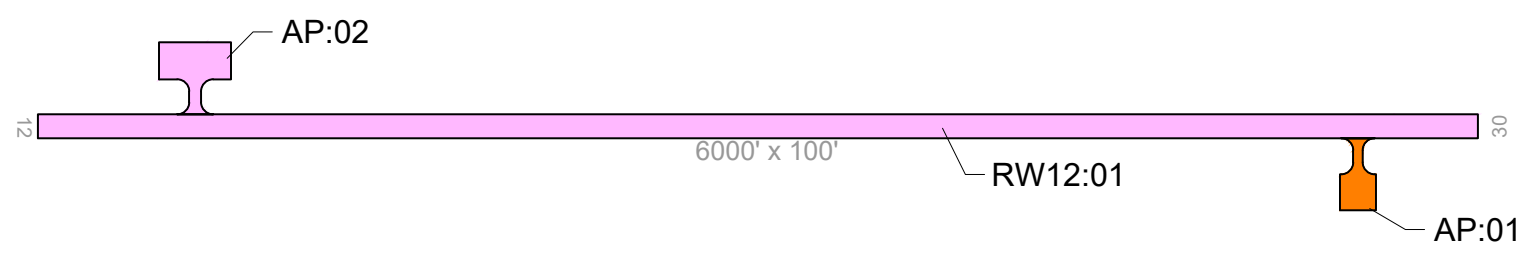
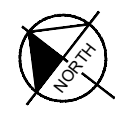

LEGEND

— BRANCH IDENTIFIER  
**RW01:10** — SECTION IDENTIFIER  
 — SECTION BOUNDARY

	PCI 86-100 GOOD
	PCI 71-85 SATISFACTORY
	PCI 56-70 FAIR
	PCI 41-55 POOR
	PCI 26-40 VERY POOR
	PCI 11-25 SERIOUS
	PCI 0-10 FAILED

### FORECASTED PAVEMENT CONDITION INDEX

Branch ID	Section ID	Surface Type	Current PCI (2024)	2025	2026	2027	2028	2029
RW12	01	AAC	55	54	51	47	43	39
AP	01	AAC	56	55	52	49	45	42
AP	02	AAC	41	40	37	34	30	27



This document, together with the concepts and designs presented herein, is an instrument of service, is intended only for the specific purpose and client for which it was prepared. Reuse of and improper reliance on this document without written authorization and adaptation by Kinney-Horn and Associates, Inc. shall be without liability to Kinney-Horn and Associates, Inc.

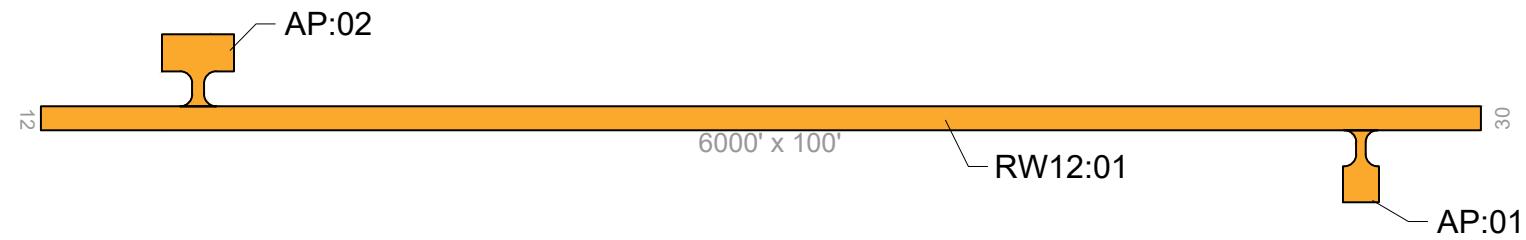

LEGEND

——— BRANCH IDENTIFIER  
**RW01:10** ——— SECTION IDENTIFIER  
 ——— SECTION BOUNDARY

MAJOR REHABILITATION		GLOBAL TREATMENT
	2025	
	2026	
	2027	
	2028	
	2029	

5-YEAR PAVEMENT NEEDS BY SECTION

Year	Branch ID	Section ID	Surface Type	Section Area (SF)	PCI at Treatment	Recommended Treatment	Treatment Category
2025	RW12	01	AAC	600,000	54	Full-Depth Reconstruction	Major Rehabilitation
2025	AP	01	AAC	45,000	55	Mill and Overlay	Major Rehabilitation
2025	AP	02	AAC	90,000	40	Full-Depth Reconstruction	Major Rehabilitation

Runway



*RW12-01-46: Rutting*



*RW12-01-66: Block Cracking*



*RW12-01-86: L&T Cracking*



*RW12-01-106: Overview*

Apron



*AP-01-05: L&T Cracking*



*AP-01-07: L&T Cracking*

# Re-Inspection Report

MDT SASP 2024

Generated Date

1/7/2025

Page 1 of 3

---

**Network:** 3U7 **Name:** Benchmark (Augusta) Airport

---

**Branch:** AP **Name:** Apron **Use:** APRON **Area:** 135,000 SqFt

---

**Section:** 01 of 2 **From:** RW12 **To:** - **Last Const.:** 1/1/2000

**Surface:** AAC **Family:** \_MDT2024 - AP AAC **Zone:** **Category:** **Rank:** P

**Area:** 45,000 SqFt **Length:** 300 Ft **Width:** 150 Ft

**Slabs:** **Slab Length:** Ft **Slab Width:** Ft **Joint Length:** Ft

**Shoulder:** **Street Type:** **Grade:** 0 **Lanes:** 0

**Section Comments:**

---

**Work Date:** 1/1/1984 **Work Type:** New Construction - AC **Code:** NC-AC **Is Major M&R:** True

---

**Work Date:** 1/1/2000 **Work Type:** AC- Mill and Overlay **Code:** AC-MO **Is Major M&R:** True

---

**Last Insp. Date:** 10/1/2024 **TotalSamples:** 11 **Surveyed:** 3

**Conditions:** PCI: 56

**Inspection Comments:**

---

**Sample Number:** 03 **Type:** R **Area:** 5000.00 SqFt **PCI:** 53

**Sample Comments:**

45 DEPRESSION L 20.00 SqFt  
48 L & T CR L 805.00 Ft  
48 L & T CR M 25.00 Ft  
52 RAVELING L 5000.00 SqFt  
56 SWELLING L 125.00 SqFt

---

**Sample Number:** 05 **Type:** R **Area:** 5000.00 SqFt **PCI:** 59

**Sample Comments:**

48 L & T CR L 555.00 Ft  
48 L & T CR M 44.00 Ft  
52 RAVELING L 5000.00 SqFt  
56 SWELLING L 100.00 SqFt

---

**Sample Number:** 07 **Type:** R **Area:** 5000.00 SqFt **PCI:** 57

**Sample Comments:**

48 L & T CR L 714.00 Ft  
48 L & T CR M 20.00 Ft  
52 RAVELING L 5000.00 SqFt  
56 SWELLING L 100.00 SqFt

<b>Network:</b>	3U7	<b>Name:</b>	Benchmark (Augusta) Airport				
<b>Branch:</b>	AP	<b>Name:</b>	Apron	<b>Use:</b>	APRON	<b>Area:</b>	135,000 SqFt
<b>Section:</b>	02	of 2	<b>From:</b>	RW12	<b>To:</b>	-	<b>Last Const.:</b> 1/1/2000
<b>Surface:</b>	AAC	<b>Family:</b>	_MDT2024 - AP AAC	<b>Zone:</b>		<b>Category:</b>	<b>Rank:</b> P
<b>Area:</b>	90,000 SqFt	<b>Length:</b>	300 Ft	<b>Width:</b>	300 Ft		
<b>Slabs:</b>		<b>Slab Length:</b>	Ft	<b>Slab Width:</b>	Ft	<b>Joint Length:</b>	Ft
<b>Shoulder:</b>		<b>Street Type:</b>		<b>Grade:</b>	0	<b>Lanes:</b>	0
<b>Section Comments:</b>							
<b>Work Date:</b>	1/1/1984	<b>Work Type:</b>	New Construction - AC		<b>Code:</b>	NC-AC	<b>Is Major M&amp;R:</b> True
<b>Work Date:</b>	1/1/2000	<b>Work Type:</b>	AC- Mill and Overlay		<b>Code:</b>	AC-MO	<b>Is Major M&amp;R:</b> True
<b>Last Insp. Date:</b>	10/1/2024	<b>Total Samples:</b>	17	<b>Surveyed:</b>	5		
<b>Conditions:</b>	PCI: 41						
<b>Inspection Comments:</b>							
<b>Sample Number:</b>	01	<b>Type:</b>	R	<b>Area:</b>	5000.00 SqFt	<b>PCI:</b>	44
<b>Sample Comments:</b>							
43	BLOCK CR	L	5000.00	SqFt			
52	RAVELING	L	4000.00	SqFt			
52	RAVELING	M	1000.00	SqFt			
<b>Sample Number:</b>	03	<b>Type:</b>	R	<b>Area:</b>	5000.00 SqFt	<b>PCI:</b>	46
<b>Sample Comments:</b>							
43	BLOCK CR	L	5000.00	SqFt			
52	RAVELING	L	4250.00	SqFt			
52	RAVELING	M	750.00	SqFt			
<b>Sample Number:</b>	07	<b>Type:</b>	R	<b>Area:</b>	5000.00 SqFt	<b>PCI:</b>	28
<b>Sample Comments:</b>							
43	BLOCK CR	L	4100.00	SqFt			
52	RAVELING	L	4100.00	SqFt			
52	RAVELING	H	900.00	SqFt			
<b>Sample Number:</b>	09	<b>Type:</b>	R	<b>Area:</b>	5000.00 SqFt	<b>PCI:</b>	37
<b>Sample Comments:</b>							
43	BLOCK CR	L	4300.00	SqFt			
52	RAVELING	L	3202.00	SqFt			
52	RAVELING	M	1700.00	SqFt			
52	RAVELING	H	98.00	SqFt			
<b>Sample Number:</b>	11	<b>Type:</b>	R	<b>Area:</b>	5000.00 SqFt	<b>PCI:</b>	50
<b>Sample Comments:</b>							
48	L & T CR	L	565.00	Ft			
48	L & T CR	M	35.00	Ft			
52	RAVELING	L	4250.00	SqFt			
52	RAVELING	M	750.00	SqFt			



<b>Network:</b>	3U7	<b>Name:</b>	Benchmark (Augusta) Airport							
<b>Branch:</b>	RW12	<b>Name:</b>	Runway 12-30	<b>Use:</b>	RUNWAY	<b>Area:</b>	600,000 SqFt			
<b>Section:</b>	01	of	1	<b>From:</b>	-	<b>To:</b>	-	<b>Last Const.:</b>	1/1/2000	
<b>Surface:</b>	AAC	<b>Family:</b>	_MDT2024 - RW AC AAC		<b>Zone:</b>		<b>Category:</b>		<b>Rank:</b>	P
<b>Area:</b>	600,000 SqFt	<b>Length:</b>	6,000 Ft	<b>Width:</b>	100 Ft					
<b>Slabs:</b>		<b>Slab Length:</b>	Ft	<b>Slab Width:</b>	Ft	<b>Joint Length:</b>	Ft			
<b>Shoulder:</b>		<b>Street Type:</b>		<b>Grade:</b>	0	<b>Lanes:</b>	0			
<b>Section Comments:</b>										
<b>Work Date:</b>	1/1/1984	<b>Work Type:</b>	New Construction - AC		<b>Code:</b>	NC-AC	<b>Is Major M&amp;R:</b>	True		
<b>Work Date:</b>	1/1/2000	<b>Work Type:</b>	AC- Mill and Overlay		<b>Code:</b>	AC-MO	<b>Is Major M&amp;R:</b>	True		
<b>Last Insp. Date:</b>	10/1/2024	<b>TotalSamples:</b>	220	<b>Surveyed:</b>	6					
<b>Conditions:</b>	PCI: 55									
<b>Inspection Comments:</b>										
<b>Sample Number:</b>	06	<b>Type:</b>	R	<b>Area:</b>	5000.00 SqFt	<b>PCI:</b>	52			
<b>Sample Comments:</b>										
43	BLOCK CR	L	4000.00	SqFt						
45	DEPRESSION	H	15.00	SqFt						
52	RAVELING	L	5000.00	SqFt						
<b>Sample Number:</b>	106	<b>Type:</b>	R	<b>Area:</b>	5000.00 SqFt	<b>PCI:</b>	59			
<b>Sample Comments:</b>										
43	BLOCK CR	L	5000.00	SqFt						
52	RAVELING	L	5000.00	SqFt						
<b>Sample Number:</b>	26	<b>Type:</b>	R	<b>Area:</b>	5000.00 SqFt	<b>PCI:</b>	55			
<b>Sample Comments:</b>										
43	BLOCK CR	L	1500.00	SqFt						
48	L & T CR	L	78.00	Ft						
52	RAVELING	L	5000.00	SqFt						
53	RUTTING	L	80.00	SqFt						
<b>Sample Number:</b>	46	<b>Type:</b>	R	<b>Area:</b>	5000.00 SqFt	<b>PCI:</b>	55			
<b>Sample Comments:</b>										
43	BLOCK CR	L	2050.00	SqFt						
48	L & T CR	L	249.00	Ft						
52	RAVELING	L	5000.00	SqFt						
53	RUTTING	L	50.00	SqFt						
<b>Sample Number:</b>	66	<b>Type:</b>	R	<b>Area:</b>	5000.00 SqFt	<b>PCI:</b>	52			
<b>Sample Comments:</b>										
43	BLOCK CR	L	3650.00	SqFt						
45	DEPRESSION	L	150.00	SqFt						
48	L & T CR	L	20.00	Ft						
52	RAVELING	L	5000.00	SqFt						
<b>Sample Number:</b>	86	<b>Type:</b>	R	<b>Area:</b>	5000.00 SqFt	<b>PCI:</b>	55			
<b>Sample Comments:</b>										
43	BLOCK CR	L	2250.00	SqFt						
45	DEPRESSION	L	146.00	SqFt						
48	L & T CR	L	213.00	Ft						
52	RAVELING	L	5000.00	SqFt						